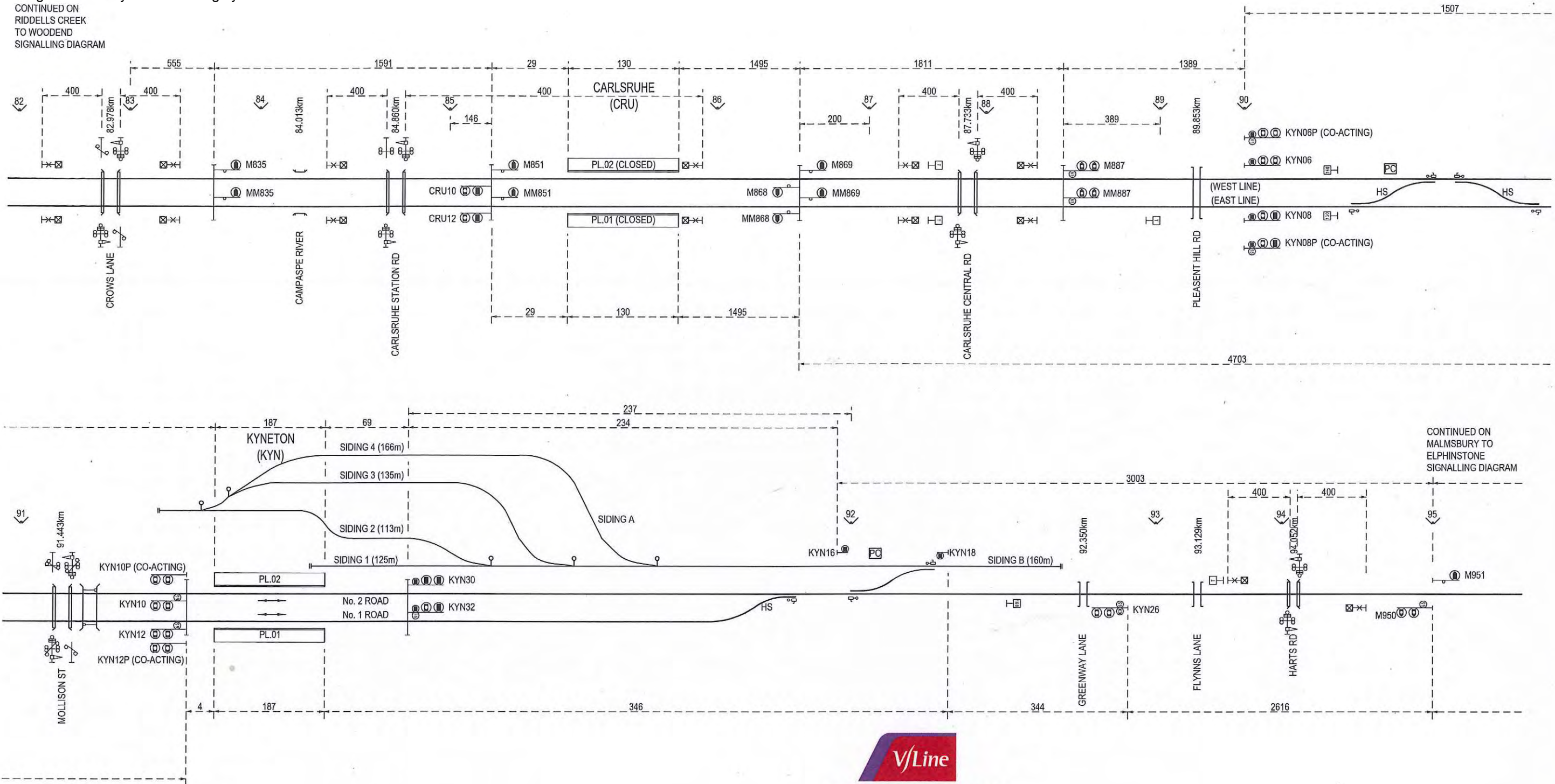

Diagram courtesy of David Langley

CONTINUED ON
RIDDELLS CREEK
TO WOODEND
SIGNALLING DIAGRAM



CONTINUED ON
MALMSBURY TO
ELPHINSTONE
SIGNALLING DIAGRAM



CARLSRUHE TO KYNETON
SIGNALLING DIAGRAM No: 42/11
(SUPERSEDES 36/05)

Showing Signal and Interlocking Arrangements to come into use on a date which will be issued by the Manager Systems and Safeworking.

[Handwritten Signature]

R. CAPPER
MANAGER SYSTEMS AND SAFEWORKING

04/04/2011